



SINGER KITCHENS

Cabinets To Go!

Singer Kitchens - Cabinets To Go! is a completely new way of buying cabinets for your kitchen. Choose from three beautiful styles, and take it home today.

Follow the simple step-by-step instructions on this sheet to create a measured rendering of your new Singer Kitchens – Cabinets To Go! Kitchen. Using the information provided, simply measure your kitchen and starting at the star (★) in the upper left hand corner of the grid, draw in your new kitchen. Each large square represents 1sq. foot. Solid lines mark each six-inch increment. Dashed lines represent each three-inch increment. As you create your new kitchen, be aware that while appliances may move several inches, fixed or permanent fixtures may not move at all.

Pick A Style:

White Medium Oak Natural Maple

Step 1: Measure the Room

Starting at the top left corner, measure the room and draw the exterior walls on the sheet. Remember to note the location of all plumbing, electrical outlets, plugs, windows and appliances. Also remember to measure the height of the walls in your kitchen from floor to ceiling.

Step 2: Mark Fixtures, Walls and Doors

Starting at the top left corner, measure the room and draw the exterior walls on the sheet. Remember to note the location of all plumbing, electrical outlets, plugs, windows and appliances.

Step 3: Draw in Your Cabinets

Using the cabinet list on the right, choose the cabinets and sizes you need to create your new kitchen.

Step 4: Purchase Your Cabinets

Visit Singer Kitchens - Cabinets To Go! at 4900 Washington Avenue (Between Carrollton Ave. & Earhart Blvd.) and purchase your new cabinets today.

CABINET LIST

WIDTH	ORDER CODE	QTY	TOTAL
WALL CABINETS			
12"W	W1230R	_____	_____
15"W	W1530R	_____	_____
18"W	W1830R	_____	_____
24"W	W2430R	_____	_____
30"W	W3030	_____	_____
36"W	W3630	_____	_____
FRIDGE CABINETS			
30"W	W3014	_____	_____
36"W	W3614	_____	_____
WALL CORNER DIAGONAL CABINET			
24"W	DC2430	_____	_____
BASE CABINETS			
12"W	B12R	_____	_____
15"W	B15R	_____	_____
18"W	B18R	_____	_____
24"W	B24R	_____	_____
30"W	B30	_____	_____
36"W	B36	_____	_____
SINK BASE CABINET			
36"W	SB36	_____	_____
DRAWER BASE CABINET			
18"W	DB18	_____	_____
BASE CORNER LAZY SUSAN CABINET			
36"W	SCR36	_____	_____
ACCESSORIES			
FILLER	F331	_____	_____
TOEKICK	TOEKICK8	_____	_____
END PANEL		_____	_____
RETURN	PEPR335	_____	_____

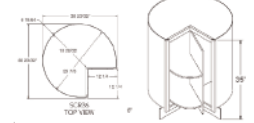
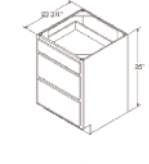
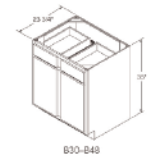
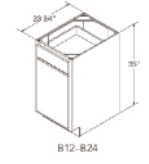
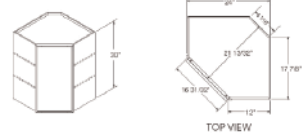
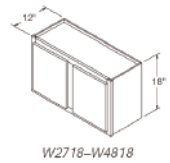
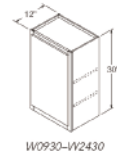

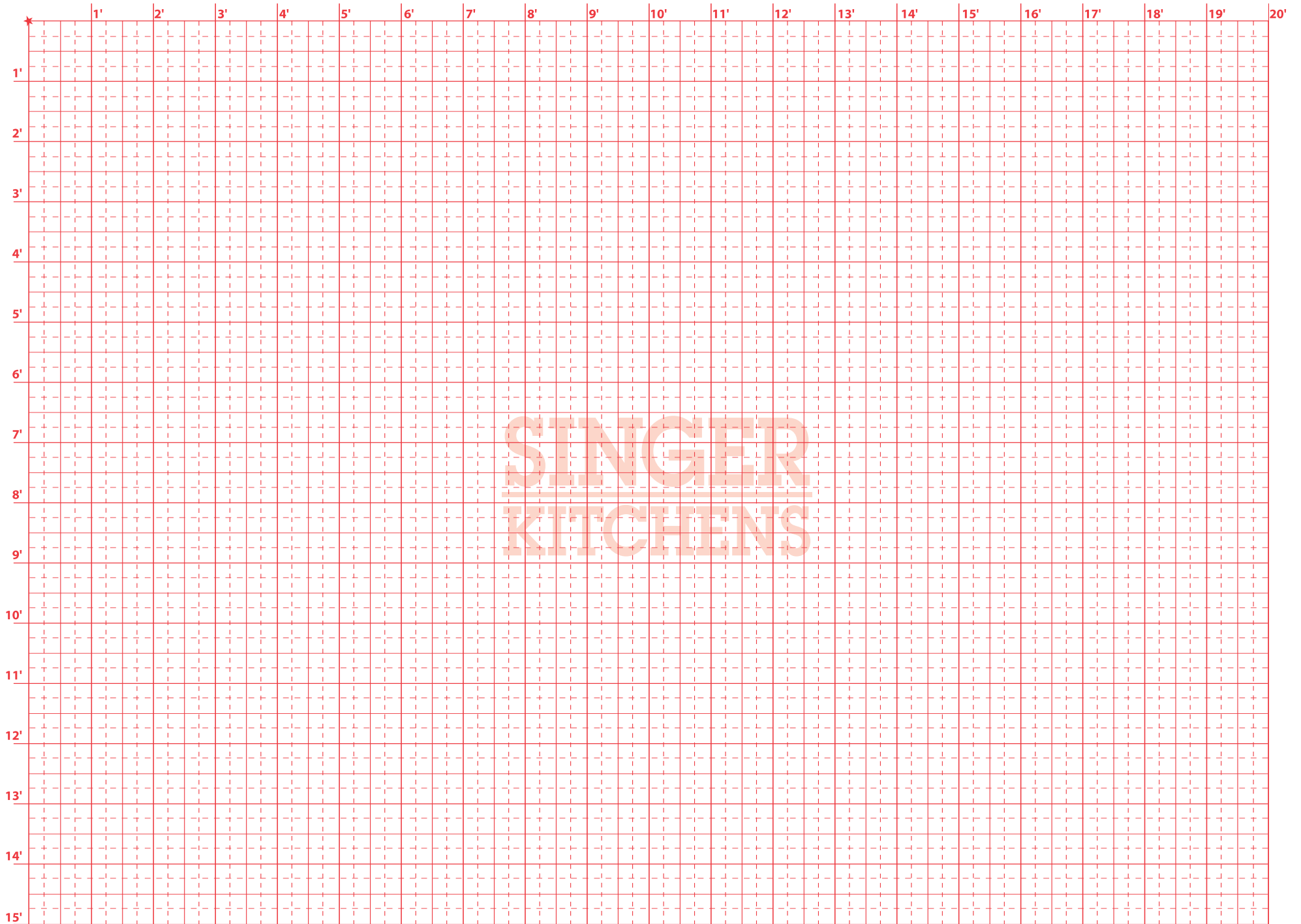

Just Four **Singer Simple** Steps To Your New Kitchen!

- Step 1:** Measure the dimensions of your kitchen.
- Step 2:** Add any additional fixtures or permanent pieces.
- Step 3:** Using dimensions on reverse side, draw in your cabinets.
- Step 4:** Visit Singer Kitchens - Cabinets To Go and purchase cabinets.